



GHARONDA COMPLEX, GAYA

at Gaya Sherghati Road, Paharpur, Near AT Gate, Gaya- 823005
RERA NO. : BRERAP00113-2/156/R-1308/2022

Unique
Creation of
Dream homes

gharondabuildcon@gmail.com ✉
+91 9334110626, 7979099327, 7004027784 📞
www.gharondabuildcon.com 🌐

A PROJECT BY
GHARONDA BUILDCON PVT LTD

GHARONDA COMPLEX, GAYA



INTRODUCING **GHARONDA COMPLEX, GAYA**

AT GAYA SHERGHATI ROAD, PAHARPUR
NEAR AT GATE, GAYA- 823005

A PRIVILEGED LIFE WITH SELECT INDULGENCES

A life where dreams take the front seat. Where pampering doesn't call for an occasion and where smart living ensures peace of mind.

Your happiness will always find a place at
GHARONDA COMPLEX, GAYA

you are not buying a house,
you are buying a lifestyle.

At last, this is what you've been searching for..



PRESENTS

Committed to superior quality
and results

PRESENTS

GHARONDA COMPLEX, GAYA

at Khesra/Plot No. 1122, Gaya Sherghati Road
Paharpur, Near AT Gate, Gaya- 823005

Features and Amenities



Fire safety



Earthquake resistant



Intercom facility



Elevator Facility



24X7 Water supply



24X7 Power backup



Commercial Space



Security

GHARONDA COMPLEX, GAYA is strategically located in one of the best residential location area of Patna with easy access to educational institutions , shopping malls, hospitals and important business and leisure hubs. The location is ideal for cutting down your commute time while enjoying a pleasantly relaxed lifestyle and nature splendors. The Project located *at Gaya Sherghati Road, Paharpur, Near AT Gate, Gaya- 823005*

- Conveniently located
- All side open area and green view
- A masterpiece of architectural design
- Provision for cross ventilation and ample natural light
- Superior Fittings in all room
- Vaastu Friendly layout



vaastu shastra
BASED



RERA NO. : BRERAP00113-2/156/R-1308/2022

A Home is Built with
LOVE AND DREAMS



**TYPICAL
(2nd to 4th FLOOR PLAN)**

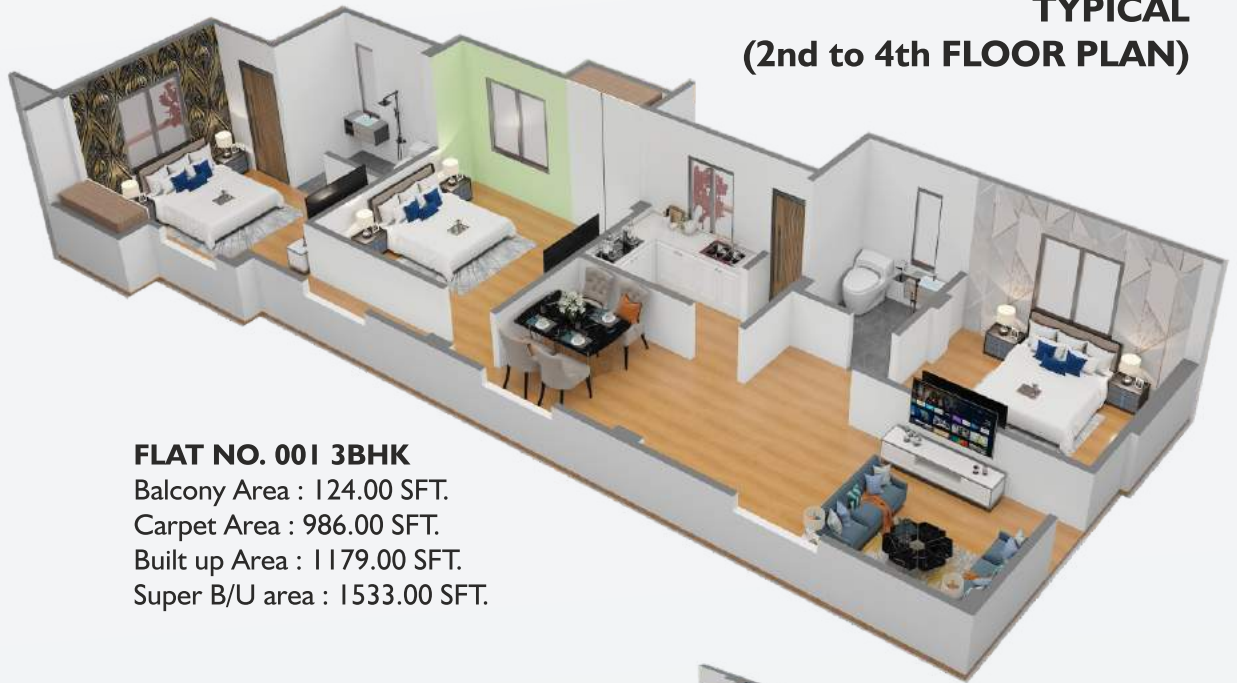

FLAT NO. 001 3BHK
 Balcony Area : 124.00 SFT.
 Carpet Area : 986.00 SFT.
 Built up Area : 1179.00 SFT.
 Super B/U area : 1533.00 SFT.



FLAT NO. 002 3BHK
 Balcony Area : 112.00 SFT.
 Carpet Area : 884.00 SFT.
 Built up Area : 1053.00 SFT.
 Super B/U area : 1369.00 SFT.



FLAT NO. 003 3BHK
 Balcony Area : 172.00 SFT.
 Carpet Area : 924.00 SFT.
 Built up Area : 1150.00 SFT.
 Super B/U area : 1495.00 SFT.



GROUND FLOOR PLAN

SHOP NO.	CARPET AREA	BUILT UP AREA	SUPER B/U AREA
SHOP-01	1061.0 SFT.	1118.0 SFT.	1621.0 SFT.
SHOP-02	285.0 SFT.	300.0 SFT.	435.0 SFT.
SHOP-03	176.0 SFT.	190.0 SFT.	275.0 SFT.
SHOP-04	984.0 SFT.	1041.0 SFT.	1509.0 SFT.

1st FLOOR PLAN

OFFICE NO.	BUILT UP AREA	SUPER B/U AREA
101	1179.00 SFT.	1533.00 SFT.
102	1053.00 SFT.	1369.00 SFT.
103	1150.00 SFT.	1495.00 SFT.

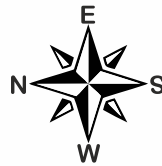

Committed to getting
the results
you Deserve

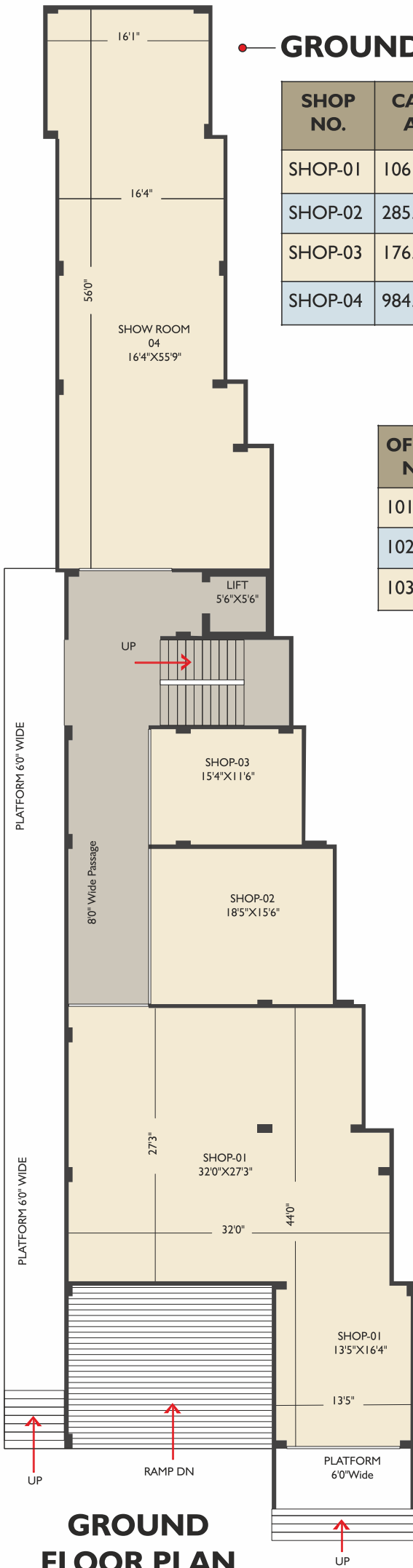

GROUND FLOOR PLAN

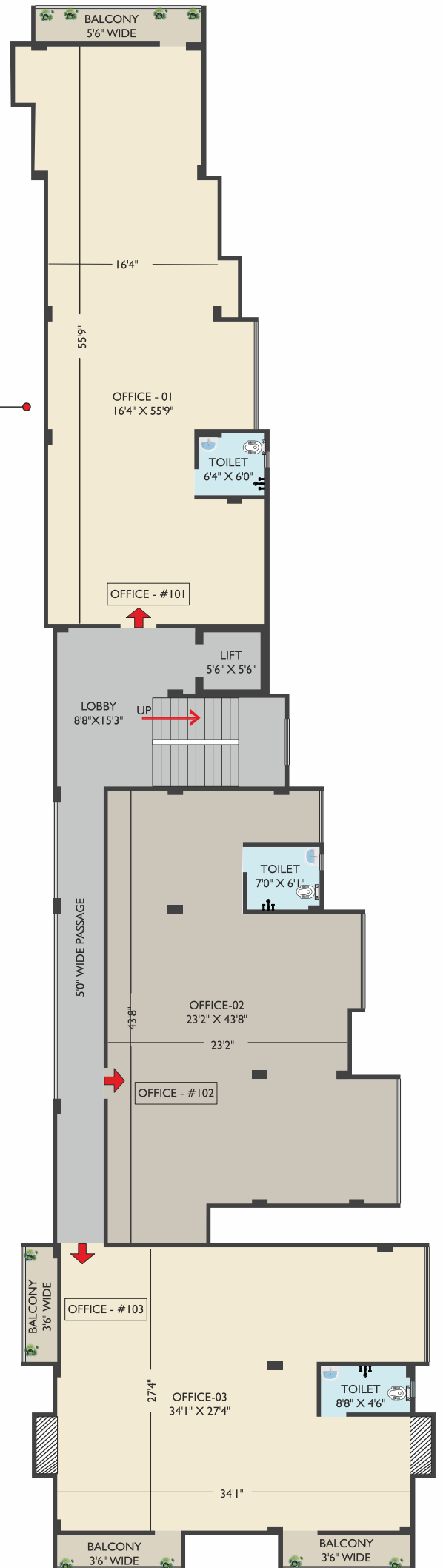

1st FLOOR PLAN

SPECIFICATION

INTERNAL WALL : All internal walls shall be wall putty.

EXTERNAL WALL : Finished with wall putty & weather coat paint.

FLOORING : Designer vitrified flooring.

KITCHEN :

- Working platform: granite slab.
- Dado 24" designer tiles

DINING SPACE : ISI mark white color hand wash basin in dining space.

BATHROOM/TOILETS :

- Wall designer bathroom concept up to 7'0" height

DOOR :

- Door frame (chaukhat) of wood with beating.
- Entrance door decorative venire/door skin.
- Flush door board ISI mark.

WINDOWS : Clear glass window or Aluminium with Grill.

ELECTRICAL:

- All internal wiring in concealed conduits with copper wires.
- All electrical modular switches accessories of Havels, Anchor, and Polycab.
- Cable point in all room.

A Home is Built with **LOVE AND DREAMS**



PAYMENT SCHEDULE

- | | | | |
|---------------------------------|-------|-----------------------------|-------|
| • At the time of Booking | : 10% | • Second Floor Roof Casting | : 10% |
| • At the time of sale agreement | : 15% | • Third Floor Roof Casting | : 10% |
| • Basement Floor Roof Casting | : 10% | • Fourth Floor Roof Casting | : 10% |
| • Ground Floor Roof Casting | : 10% | • Masonry Work/Flooring | : 10% |
| • First Floor Roof Casting | : 10% | • 20 days before possession | : 5% |

Perfect Choice for your Dream's...



Location

Not to scale



OFFICE ADDRESS

G-I, Mahadevi Apartment, Kashinath Lane, East
Lohanipur, Patna- 800003

SITE ADDRESS

Khesra/Plot No. 1122, Gaya Sherghati Road,
Paharpur, Near AT Gate, Gaya- 823005



gharondabuildcon@gmail.com



+91 9334110626, 7979099327, 7004027784



www.gharondabuildcon.com

This Brochure is purely conceptual and not a legal offering.
The specification are only indicative and some of these can be changed in consultation with the architect at the discretion of the builder.